

## **Mu-8000 Caster/Camber Plate 79-04 Mustang**

***Position plate over the opening in strut tower and center.***

***Then drill four 7/16" holes.***

***For all Fox applications will work as is on all SN95 applications.***

***Position CC plates from the underside of the strut tower with con bearing pointed down and closest to the firewall.***

***Install and tighten all 4 nuts.***

***Then install strut shaft and spacers.***

***Repeat on other side.***



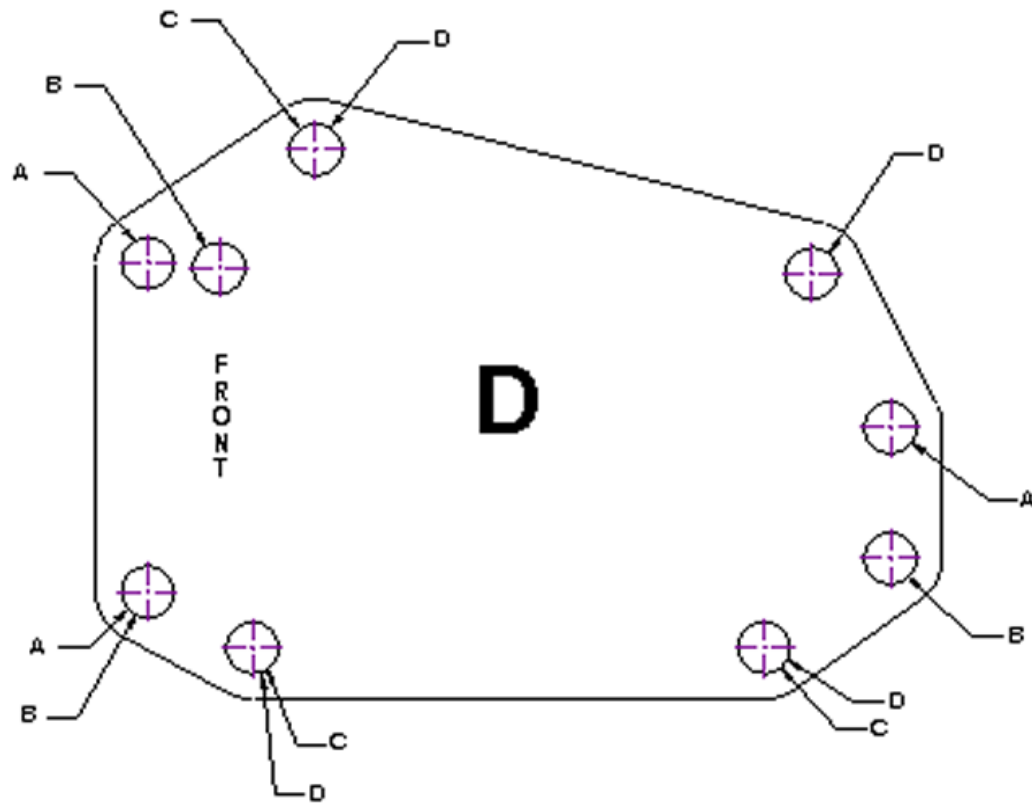

- A. 79-90 FOX
- B. 91-93 FOX
- C. 94-04 SN35
- D. DRILL 7/16" HOLE

	DRAWN	DATE				
	CHECKED					
	CC					
INFO		SIZE	PSCHED.	DWGNO.	OSIDE TEMPLATE	REV
APPROVED		A				

ZONE	REV	DESCRIPTION	DATE	APPROVED

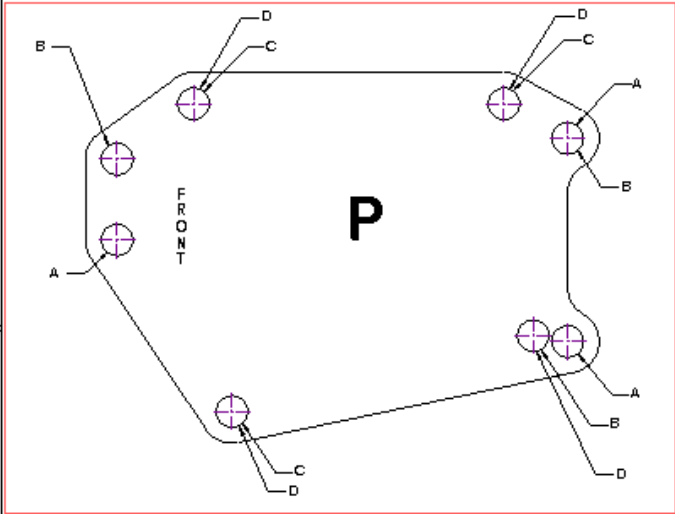

A. 79-80 FOX  
 B. 91-93 FOX  
 C. 94-04 SN85  
 D. DRILL 7/16" HOLE

	DRAWN	DATE			
	CHECKED				
	CC				